

# SAMPLE BASEMENT FINISH FLOOR PLAN AND ANCILLARY INFORMATION

Walls - 2" x 4" studs, 16" c/c w/ treated bottom plate and 1/2" drywall finish

Ceiling - 1/2" drywall applied to bottom of floor joist or a suspended (drop) ceiling system installed pursuant to the manufacturer's specifications.

Supply and return air ducts as specified on floor plan

Access panels will be supplied for and water and gas shut-offs and electrical junction boxes

Electrical receptacles will be placed w/i 6' of a door opening and a minimum of 12' c/c otherwise

Switches and lighting will be a specified on floor plan

Bath exhaust will be terminated outside of the building envelope

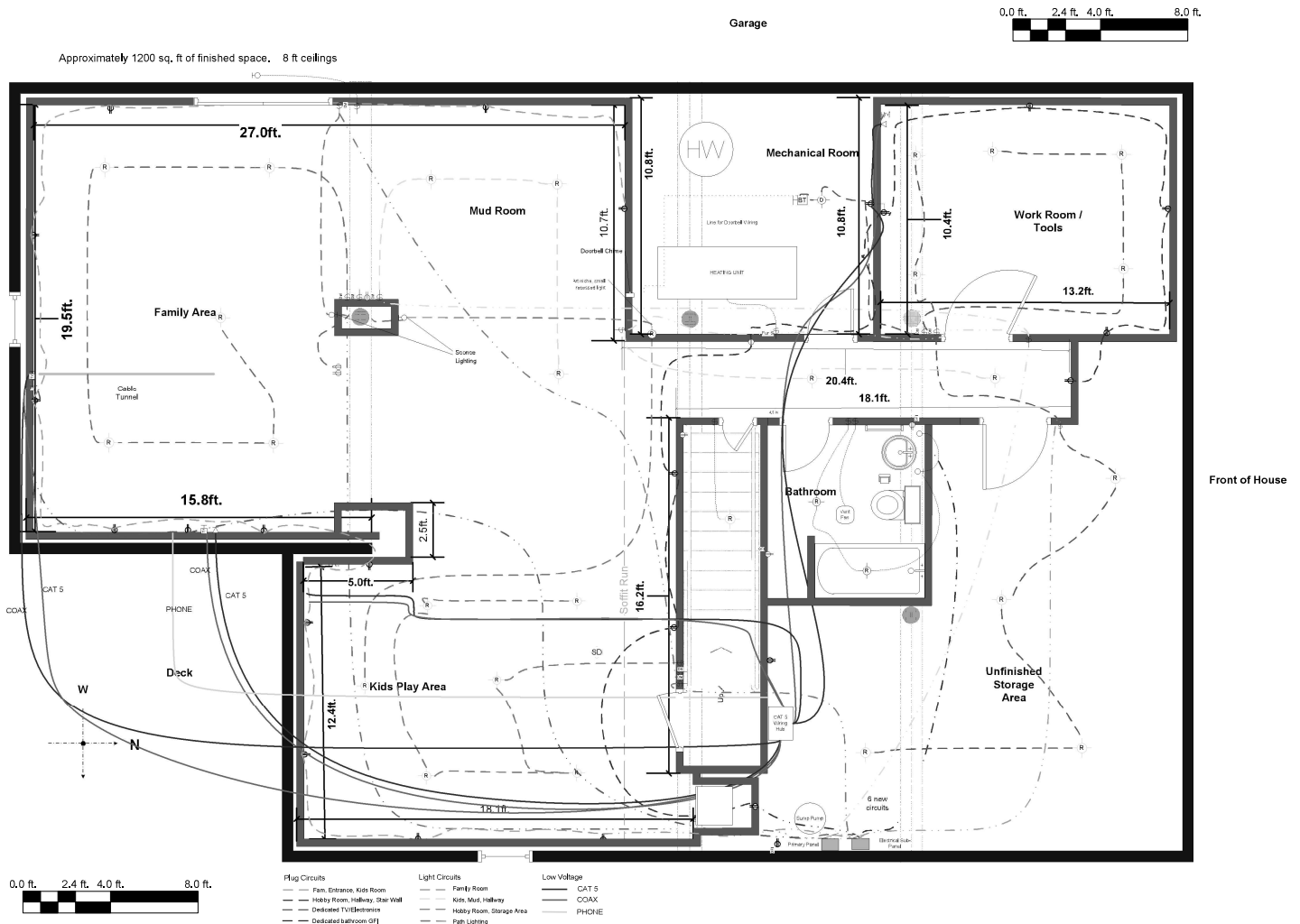

Rooms are identified on the floor plan

Furnace and hot water heater are located on floor plan

Smoke and carbon monoxide alarms are located on floor plan