



3382 Glenwood Blvd. · Reminderville, Ohio 44202 · 330-562-1234 · www.Reminderville.com

BASEMENT FINISH/KITCHEN BATH RENOVATIONS

Before performing any interior alterations such as finishing a basement or renovating a kitchen or bath, permits must first be obtained from the Building Department.

At the time of applying for a permit, three (3) copies of the plan for the alterations such as a basement finish or a kitchen or bath renovation shall be submitted and will require the following:

- (a) Floor plan – in scale, depicting the entire floor with dimensions, identifying the area proposed for renovation or finish and identifying the use of the room.
- (b) The location of all electrical outlets, lighting fixtures, switching, supply air diffusers and return air venting and any other mechanical appurtenance.
- (c) The location of smoke detectors and carbon monoxide alarms.

Bedrooms are not a permitted use in the basement unless egress requirements have been met. Contact the Building Official for more information.

The Residential Code of Ohio requires a smoke detector in each bedroom and on each level as well as a carbon monoxide alarm in the immediate vicinity of the sleeping area, but outside of the bedroom when there is work requiring a permit.

After the plans have been reviewed by the Building Official a permit may be secured upon receipt of the required fees.

SAMPLE BASEMENT FINISH FLOOR PLAN AND ANCILLARY INFORMATION

Walls - 2" x 4" studs, 16" c/c w/ treated bottom plate and 1/2" drywall finish

Ceiling - 1/2" drywall applied to bottom of floor joist or a suspended (drop) ceiling system installed pursuant to the manufacturer's specifications.

Supply and return air ducts as specified on floor plan

Access panels will be supplied for and water and gas shut-offs and electrical junction boxes

Electrical receptacles will be placed w/i 6' of a door opening and a minimum of 12' c/c otherwise

Switches and lighting will be a specified on floor plan

Bath exhaust will be terminated outside of the building envelope

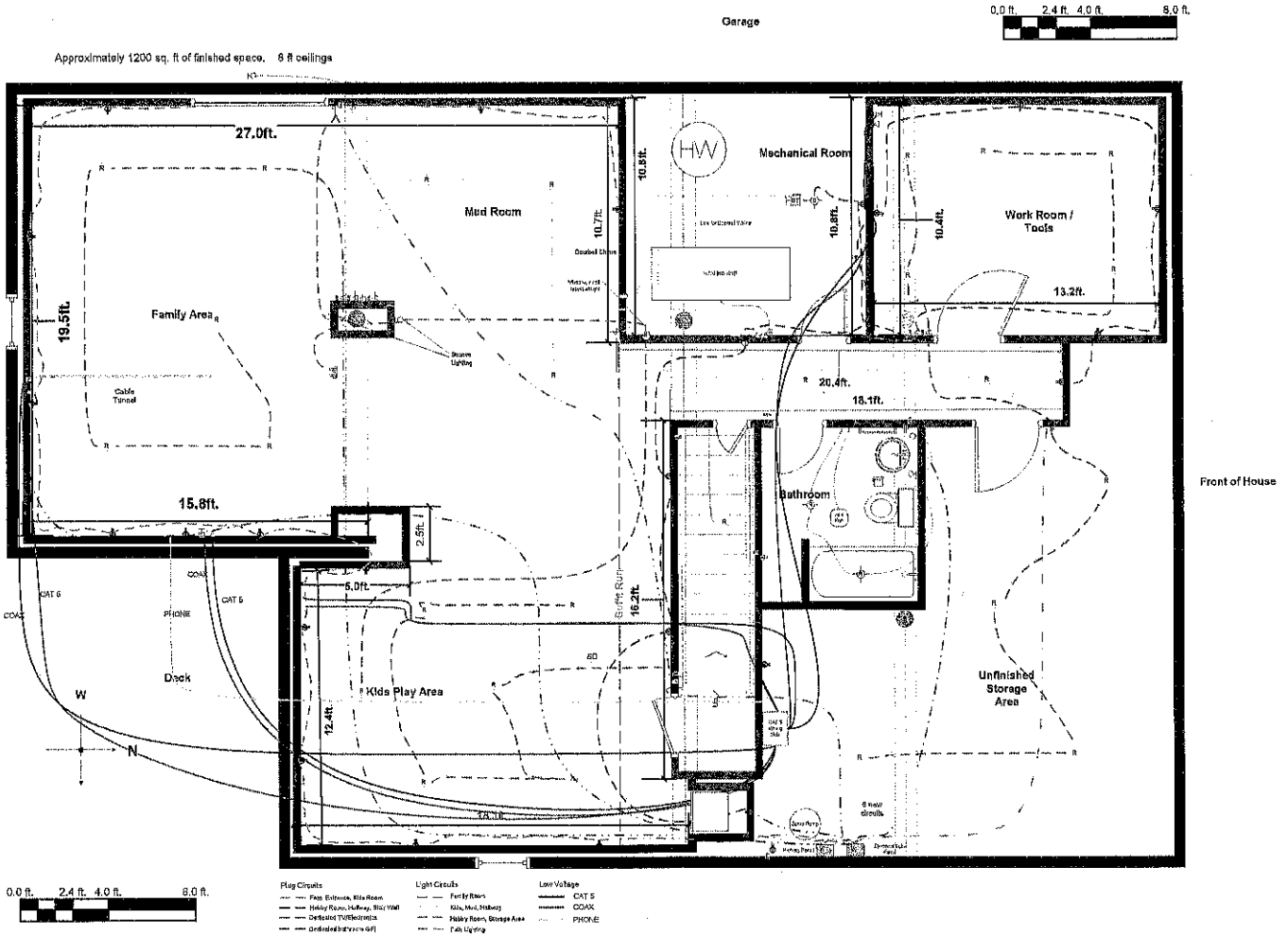

Rooms are identified on the floor plan

Furnace and hot water heater are located on floor plan

Smoke and carbon monoxide alarms are located on floor plan